

# ROHS

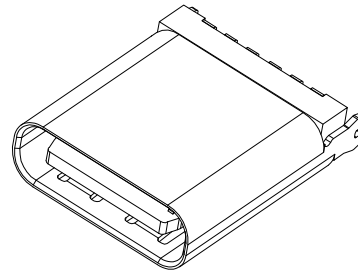

B12	GND
B9	VBUS
B5	CC2
A5	CC1
A9	VBUS
A12	GND
PIN	SIGNAL NAME

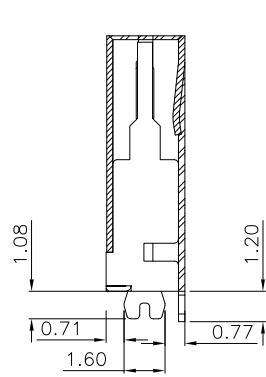
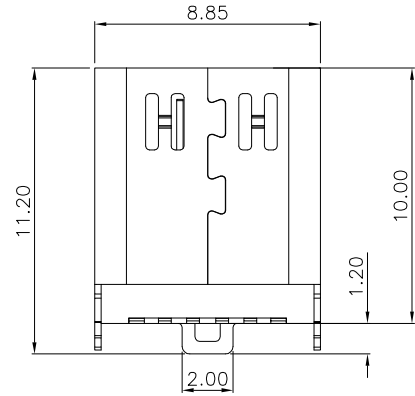
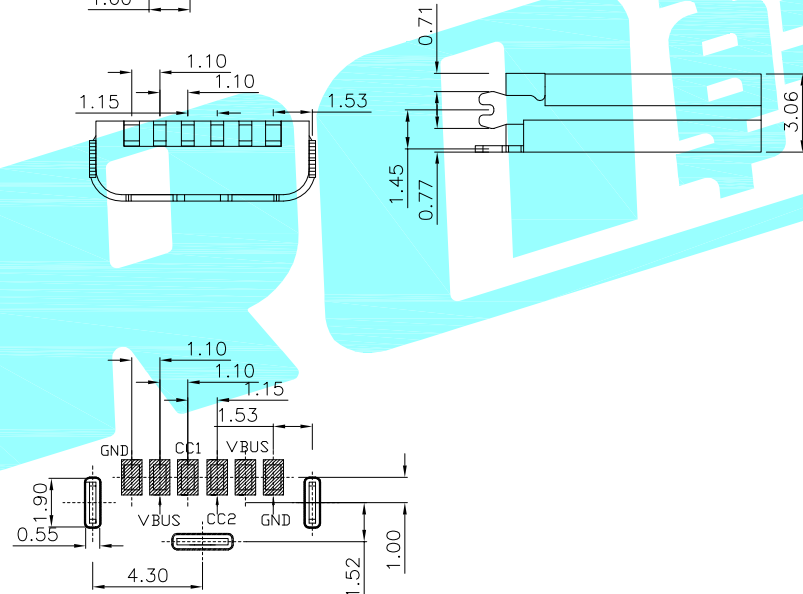
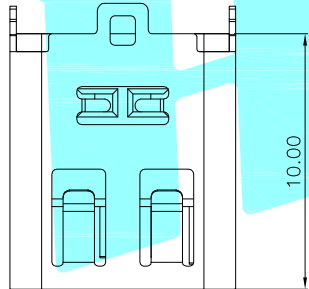
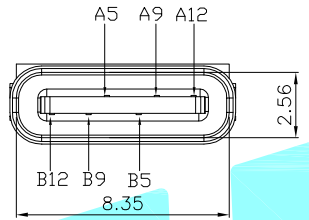

RECOMMEND P.C.B LAYOUT (COMPONENT SIDE)  
TOLERANCE FOR PCB LAYOUT IS ±0.05

**NOTES:**

**1. MATERIAL:**

MOLDING: LCP UL94 V-0  
CONTACT: COPPER ALLOY.  
GOLD PLATED Min ON CONTACT AREA, 80u"  
Min TIN (LEAD FREE) ON SOLDER AREA,  
SHELL: SUS, T=0.30±0.03mm  
30u" NICKEL PLATING OVER ALL.

**2. MECHANICAL:**

INSERTION: 5~20N.  
EXTRACTION: 6~20N AFTER TEST.  
DURABILITY: 5000 CYCLES

**3. ELECTRICAL:**

CURRENT: 3A FOR VBUS;  
1.25A FOR GND PIN.  
0.25A FOR OTHER.

VOLTAGE: 5V  
WITHSTANDING VOLTAGE: 100V AC R.M.S.  
CONTACT RESISTANCE: 100mΩ MAX.  
INSULATION RESISTANCE: 100MΩ MIN.

APPROVALS		DATE	 ELECTRONICS CO.,LTD										
DRAWN	LIUCAN	2022.08.17				TITLE:	USB CONNECTOR						
CHECKED			PART NO.	TYPE-C-31-D-02									
APPROVALS			UNIT: mm	SCALE: 1:1	PROJ:								
TOLERANCES ARE		<table border="1"> <tr><td>30~以上</td><td>±0.30</td></tr> <tr><td>10~30</td><td>±0.25</td></tr> <tr><td>5~10</td><td>±0.20</td></tr> <tr><td>~ 5</td><td>±0.15</td></tr> </table>	30~以上	±0.30	10~30	±0.25	5~10	±0.20	~ 5	±0.15	ANGLE	DRAWING NO.	SHEET 1 OF 1
30~以上	±0.30												
10~30	±0.25												
5~10	±0.20												
~ 5	±0.15												

ECN NO.	REV.	DATE.	NEW	CHANGE.	CHECK.	APPRO.
	A					
			DESCRIPTION.			