

\*Contact and Insulation dose not apply on between frame and common Terminal

Circuit Diagram PCB Layout(Pattern side)

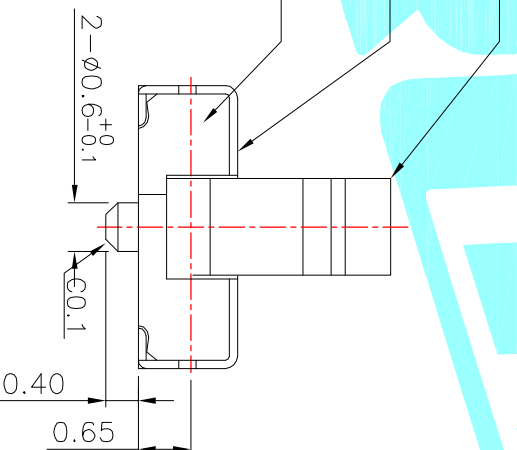
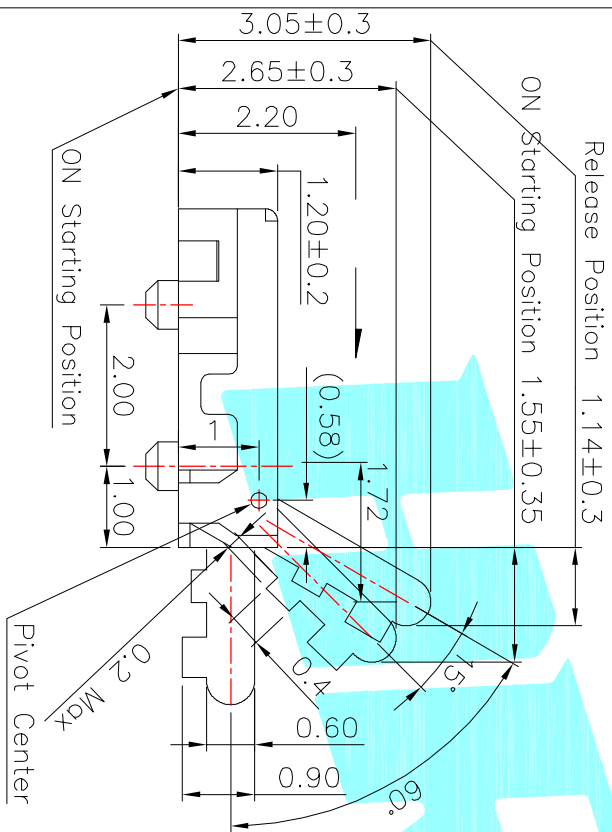
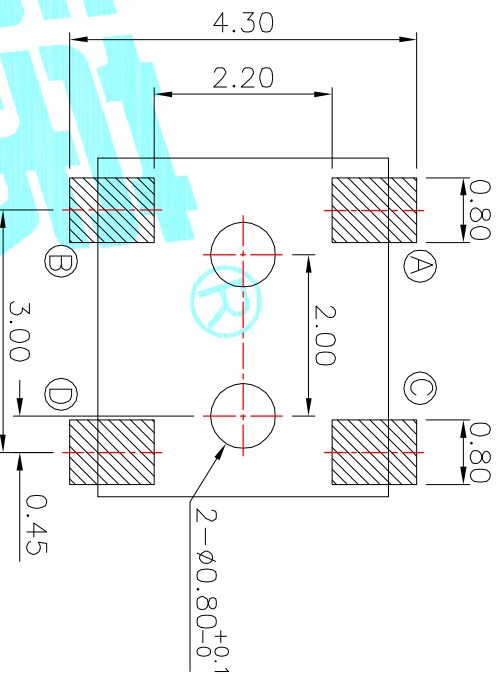

NOTE:  
Operating Force: 30gf Max

ITEM	PART NAME	TER'NO.	QTY.	MATERIAL	FINISHING	REMARK
①	Slider	---	1	Polyamide	Black	94HB
②	Cover	---	1	Phosphor Bronze	Tin Plated	---
③	Base	---	1	PPHS Resin or LCP Resin	Black	94V-0
④	Terminal	---	2	Phosphor Bronze	Ag Plated	---
⑤	Contact Spring	---	1	Phosphor Bronze	Ag Plated	---
⑥	Cam	---	1	PPHS Resin	Black	94V-0

PART NO.	
K5-1621UA-02	K5-1621UN-02

APPROVALS		DATE		TITLE:	
DRAWN	J.X.Zhang	DATE	2014/7/16	DETECTOR SWITCHES	
CHECKED					
APPROVALS		PART NO.		SCALE: 1:1	
TOLERANCES ARE		30~12.5 ±	±0.30	ANGLE	±2°
10~30	±0.20	5~10	±0.15	UNIT: mm	DRAWING NO.
~5	±0.10			SCALE: 1:1	SHEET 1 OF 1



ELECTRONICS CO.,LTD

ECN NO.	REV.	DATE.	DESCRIPTION.
	A		NEW

CHANGE.	CHECK.	APPRO.

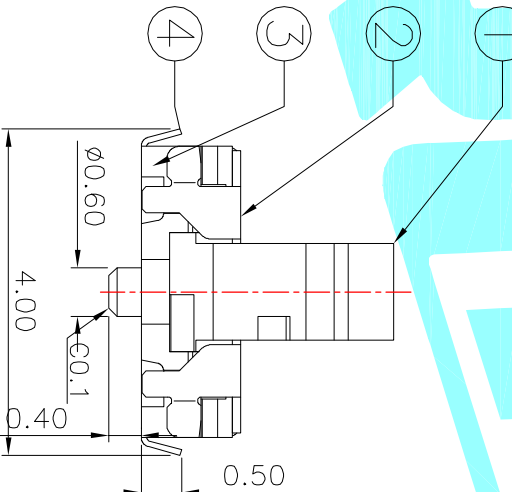
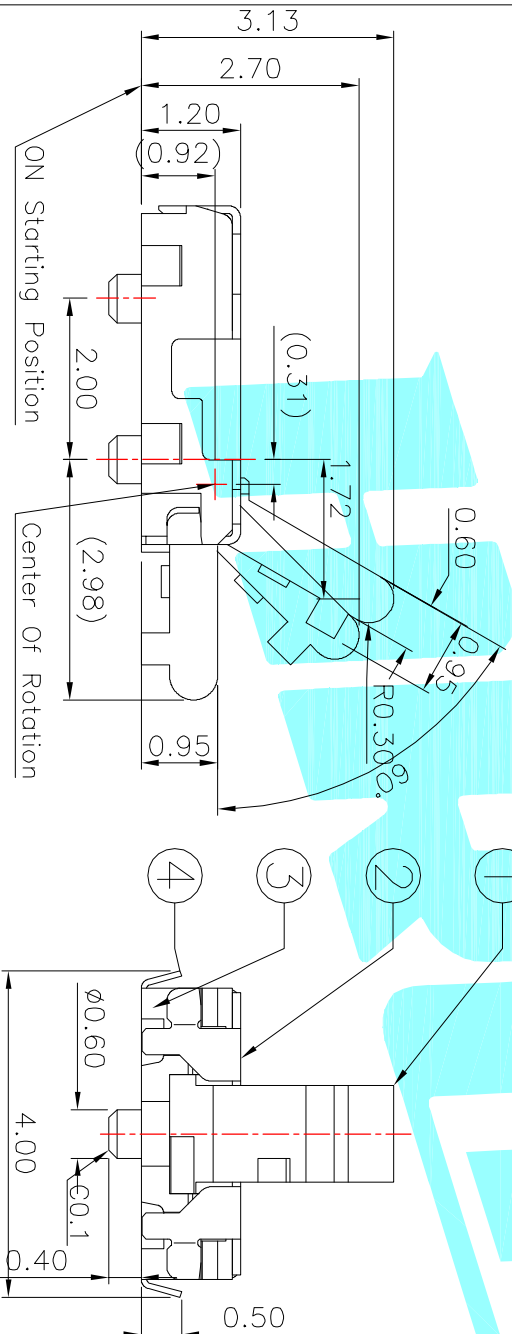
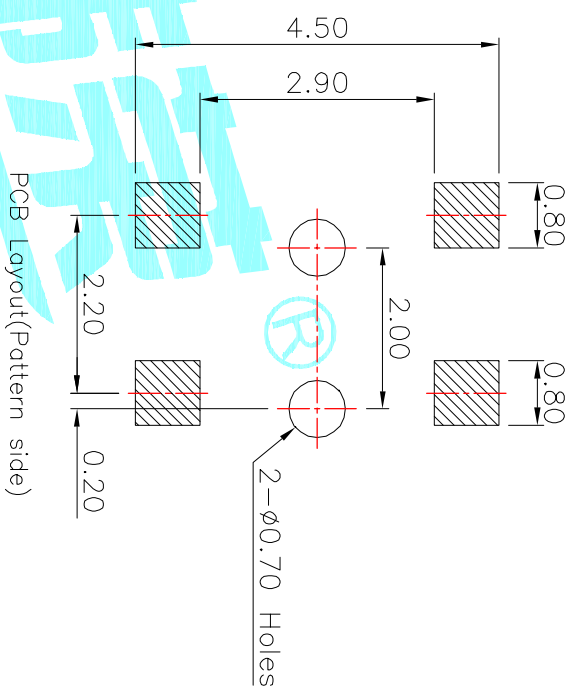
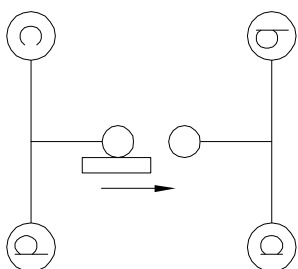
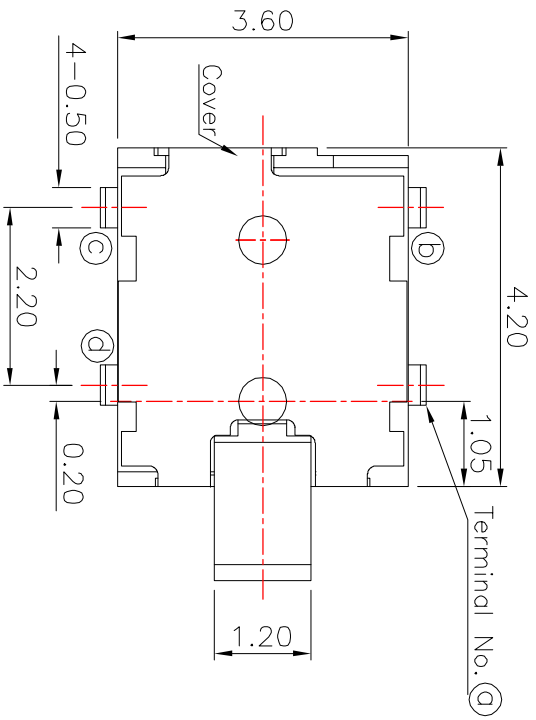

NOTE:  
Operating Force: 35gf Max

PART NO.		K5-1621UA-01	K5-1621UN-01
DRAWN		J.X.Zhang	2013/9/5
CHECKED			
APPROVALS			
TOLERANCES ARE		30~12.5 ±	±0.30
		10~30	±0.20
		5~10	±0.15
		~5	±0.10
ANGLE		±2'	
UNIT: mm		SCALE: 1:1	PROJ:
DRAWING NO.			SHEET 1 OF 1

ITEM	PART NAME	TER'NO.	QTY.	MATERIAL	FINISHING	REMARK
①	Slider	---	1	Polyamide	Black	94HB
②	Cover	---	1	Phosphor Bronze	Tin Plated	---
③	Base	---	1	PPHS Resin or LCP Resin	Black	94V-0
④	Terminal	---	4	Phosphor Bronze	Ag Plated	---
⑤	Contact Spring	---	1	Phosphor Bronze	Ag Plated	---
⑥	Cam	---	1	PPHS Resin	Black	94V-0

DRAWN		J.X.Zhang	2013/9/5
CHECKED			
APPROVALS			
TITLE:		DETECTOR SWITCHES	
PART NO.		ELECTRONICS CO.,LTD	

ECN NO.	REV.	DATE.	DESCRIPTION.	CHANGE.	CHECK.	APPRO.
	A		NEW			